

**Calvin A. P. Stanley, Esther Mae Bowman Hidle,**  
**Power of Attorney**  
**Parcel #: 01523385**

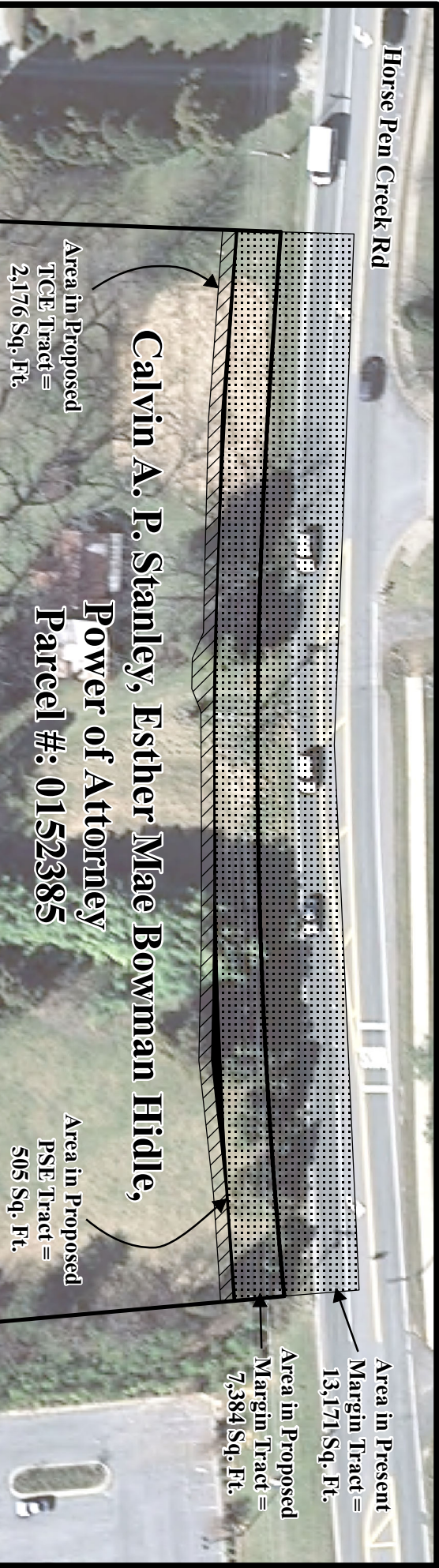

**Calvin A. P. Stanley, Esther Mae Bowman Hidle,**  
**Power of Attorney**  
**Parcel #: 01523385**

**Site Map 1218**

**Project #: P04945-01 - Horse Pen Creek Road Widening**  
**Owner: Calvin A.P. Stanley,**  
**Esther Mae Bowman Hidle, Power of Attorney**  
**Address: 2843 Horse Pen Creek Road**  
**Parcel #: 01523385**

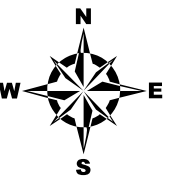

**Engineering Map 1218**  
**Compiled By: Brian J. Gillies**  
**3-16-2015**