

Keeley Park Master Plan Update



Tuesday, April 12, 2016
Vonda Martin, Park Planner

Keeley Park Master Plan Update

Objectives

- Update on Master Plan process
- Recommended Priorities for site improvements
- Next Steps



Keeley Park Master Plan Update



Public Input – Community Survey (2/1 – 3/6)

- 234 responses
- 85% from Greensboro and McLeansville
(72 % Greensboro residents / 13% McLeansville residents)

Community Conversation Series

- Meeting 1 (February 11): Site Analysis / Public Input
- Meeting 2 (March 10): Conceptual Plan
- Meeting 3 (March 17): Master Plan Reveal

Parks and Recreation Commission Presentations

- January 13, 2016
 - Request PRC Representation on Project Team
- March 9, 2016
 - Update on Master Planning Process



Keeley Park Master Plan Update

Highest Priority of Recommended Site Improvements

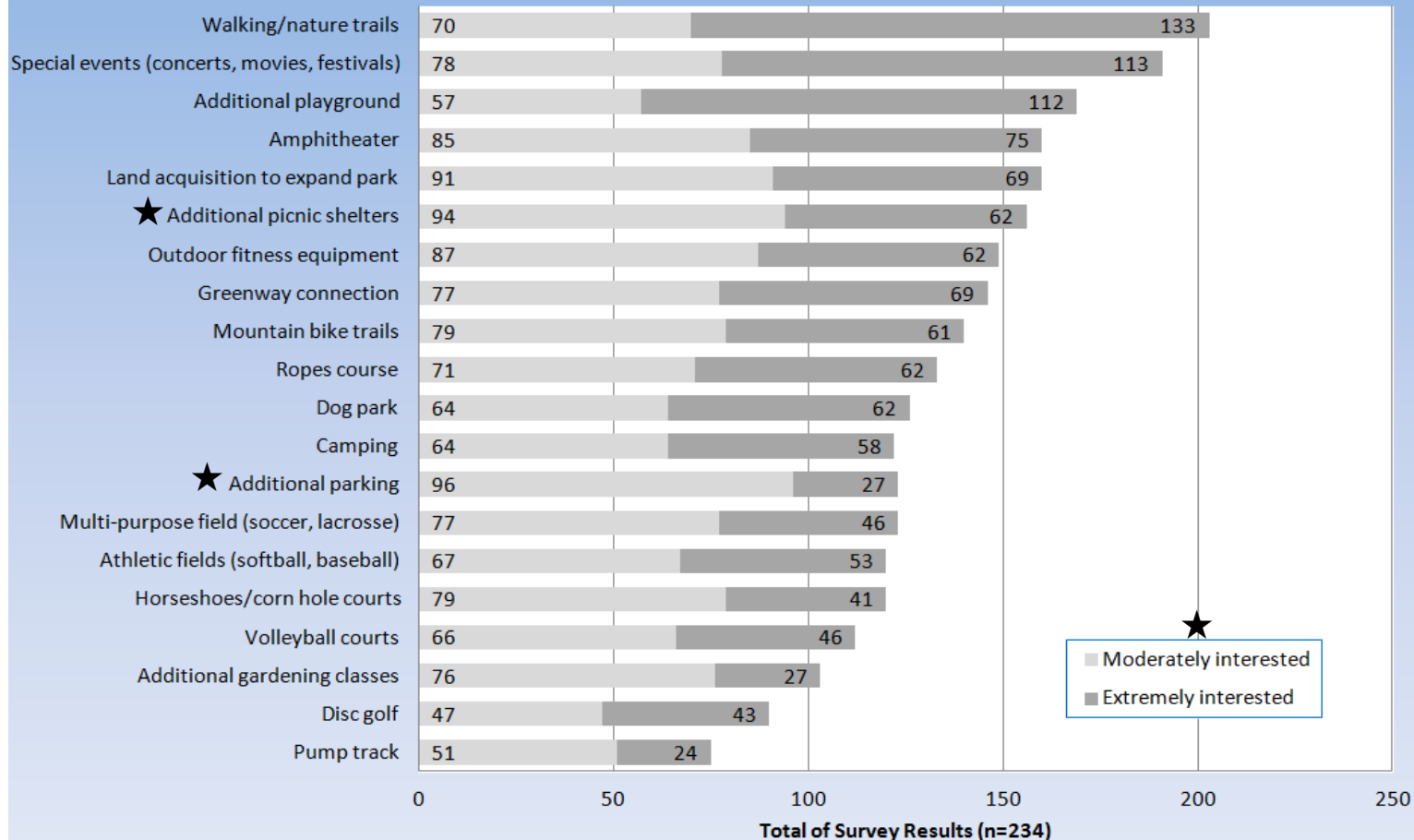

Keeley Park Master Plan Update

Recommended Site Improvements from Public Input



- Combined overall interest: Additional walking/nature trails

Survey Results (n=234) & Community Conversation #1

Keeley Park Master Plan Update

Recommended Site Improvements from Public Input



- Most moderate interest: Additional parking and more picnic shelters

Survey Results (n=234) & Community Conversation #1

Keeley Park Master Plan Update

Recommended Program Improvements



Survey Results (n=234) & Community Conversation #1



Keeley Park Master Plan Update



KEELEY PARK MASTER PLAN UPDATE
- CITY OF GREENSBORO -

04.04.2016
PREPARED BY: STEWART



Keeley Park Phase II

KEELEY PARK PHASE II PART PROJECT

PART SITE PLAN PREPARED FOR: CITY OF GREENSBORO
PROPERTY SIZE: 113.95 ACRES
PREPARED ON: 04.01.2016

PART REQUEST

PHASE 1 DEVELOPMENT

- A - OUTDOOR FITNESS EQUIPMENT
- B - WALKING TRAILS - 3,085 LF
- C - COMMUNITY GARDEN RENOVATION & EXPANSION
- D - CORN HOLE - 4 COURTS
- E - BEGINNER MOUNTAIN BIKE TRAIL - 2,968 LF
- F - PLAYGROUND RENOVATION FOR INCLUSIVE PLAY
- G - SPRAYGROUND RENOVATION W/ SHADE STRUCTURE
- H - 9-HOLE DISC GOLF COURSE (FRONT 9)
- I - FESTIVAL FIELD
- J - SHELTERS (3)
- K - SHELTER/RESTROOM BUILDING

CONCURRENT CONSTRUCTION

- 1 - ADDITIONAL PARKING (+/-156 SPACES)
- 2 - BEGINNER MOUNTAIN BIKE TRAIL - 1,614 LF
- 3 - 9-HOLE DISC GOLF COURSE (BACK 9)
- 4 - INTERMEDIATE MOUNTAIN BIKE TRAIL - 6,696 LF
- 5 - PLAYGROUND SURFACING FOR ADA

FUTURE FACILITIES

- 5 - NORTHEAST COMMUNITY TRAIL CONNECTION
- 6 - ADDITIONAL PARKING (+/-24 SPACES)
- 7 - OUTDOOR CLASSROOM
- 8 - AMPHITHEATRE
- 9 - ARBORETUM WALK - 3,502 LF
- 10 - DOG PARK - LARGE DOGS
- 11 - DOG PARK - SMALL DOGS
- 12 - SHELTER/RESTROOM BUILDING
- 13 - SOUTHERN ENTRANCE & PARKING LOT(40 SPACES)

LEGEND

- PART REQUEST
- CONCURRENT CONSTRUCTION
- FUTURE FACILITIES
- EXISTING FACILITIES
- PARK BOUNDARY
- UTILITY EASEMENTS

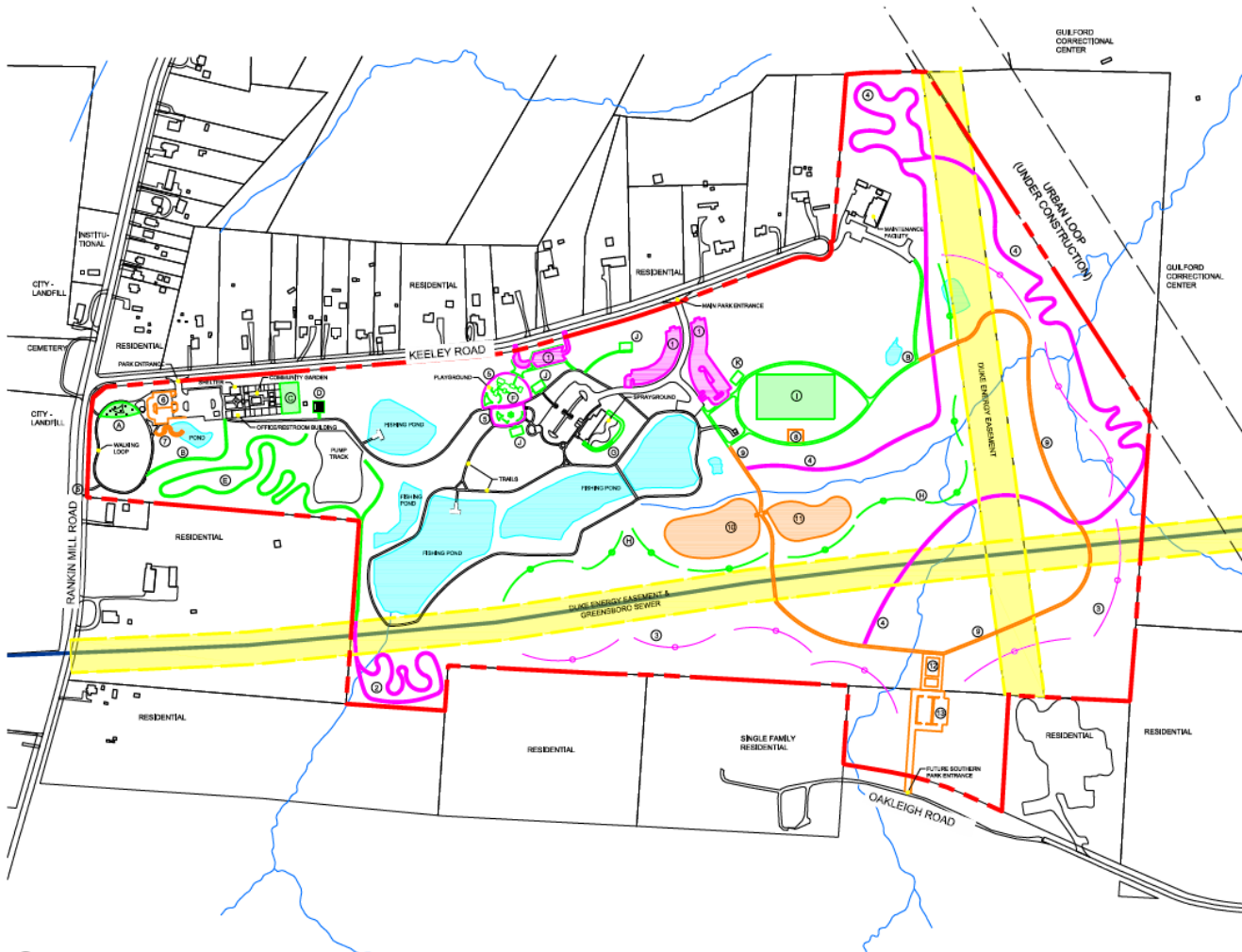

Keeley Park Master Plan Update

Next Steps

- April 12, 2016 – Council Committee Meeting
 - Presentation for Keeley Park Master Plan Update
- April 13, 2016 – Parks and Recreation Commission Meeting
 - Present recommendations for Master Plan Update and PARTF project approval
- April 19, 2016 – City Council Meeting
 - Present recommendations for Master Plan Update and PARTF project approval
- May 2, 2016 – PARTF Grant Deadline
 - Application Due by 5:00 PM

